



T- Hangar Diagrams

Northeast T-Hangars

| | | |
|--|---|----------|
|  | = | \$596.40 |
|  | = | \$679.89 |
|  | = | \$811.10 |

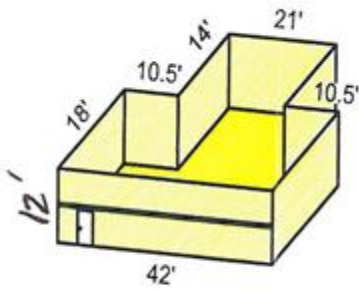

BAY 1 - 7

Approx. 1,050 sq. ft.

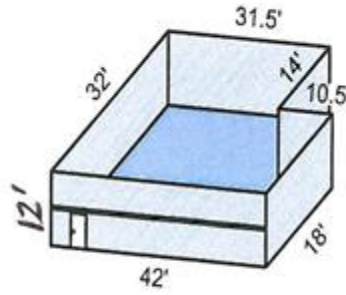

BAY 8

Approx. 1,197 sq. ft

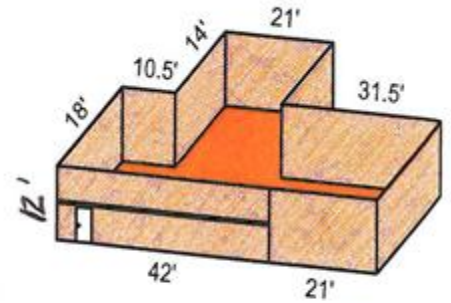

BAY 2X

Approx. 1,428 sq. ft.

Northeast T-hangar

Approximate door opening height: 11'8"

**Prices will adjust May 1st.*

T- Hangar Diagrams Southwest T-Hangars

N54-42

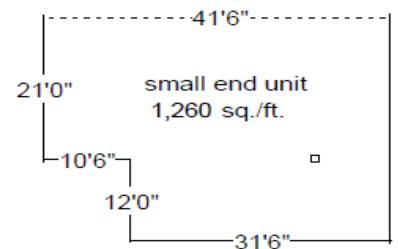
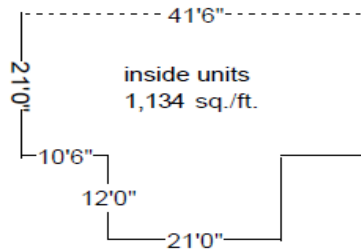
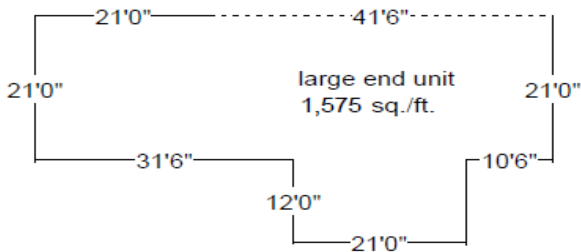

N60-45

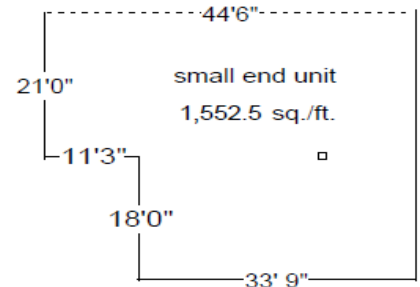
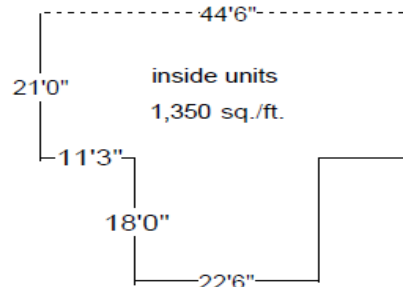
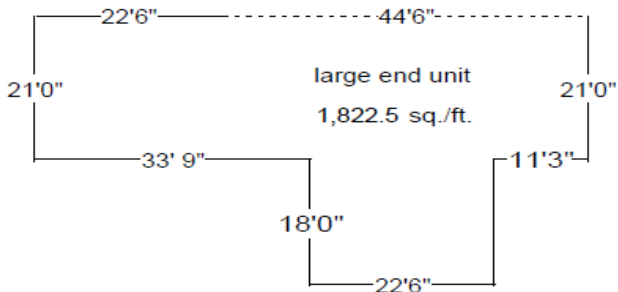

N54-42 (TH50)

Large End Unit (50-2) = \$894.60

Inside Units (50-3 thru 50-10) = \$644.11

Small End Unit (50-1) = \$715.68

Approximate door opening height: 11' 4"

N60-45 (TH51)

Large End Unit (51-9) = \$1,035.18

Inside Units (51-1 thru 51-8) = \$766.80

Small End Unit (51-10) = \$881.82

Approximate door opening height: 13' 5"

**Prices will adjust May 1st.*